

# 大容量分块料斗

## Bulk Hopper

---

自动定量分块料斗  
Automatic Dosing and Portioning Hopper



Sveba-Dahlen大容量料斗，由光电传感器控制，自动定量分块，能够均匀准确地供料给分块机或者类似装置。

Sveba-Dahlen Bulk Hopper is a photocell controlled automatic dosing and portioning hopper that enables smooth and even dough feed into a divider or similar equipment.

产品特点 and 优势

料斗容量575升或约可容纳约300公斤面团

料斗上安装有2个光电传感器，可很好的控制切割和面团料位

可安装在可移动传输带上同时供给两条独立生产线

不锈钢材质

400mm气动面团切割刀

FEATURES AND BENEFITS

*Volume 575 liters or approximately 300 kg of dough capacity*

*Two photocells mounted on the hopper for perfect control of cutting and dough level feed*

*Can be mounted on movable racks for feeding two separate lines*

*Bulk hopper in stainless steel*

*400 mm pneumatic controlled dough knife*

技术参数 SPECIFICATIONS

BULK HOPPER

电源	1 X 230V
POWER SUPPLY	1 X 230V
压缩空气	6 BAR
COMPRESSED AIR	6 BAR

选项

不锈钢支架

料斗润滑

独立的电箱

安全防护罩可定制

不沾涂层料斗

料斗可定制

不沾涂层切割刀

带刮刀的面团输送带，水平安装在料斗底部

OPTIONS

*Stainless steel frame*

*Hopper lubrication*

*Separate electrical cabinet*

*Customized safety guard*

*Non-stick coated hopper*

*Customized bulk hopper*

*Non-stick coated crossbar knife*

*Dough conveyor with scraper – horizontally mounted under the bulk hopper*

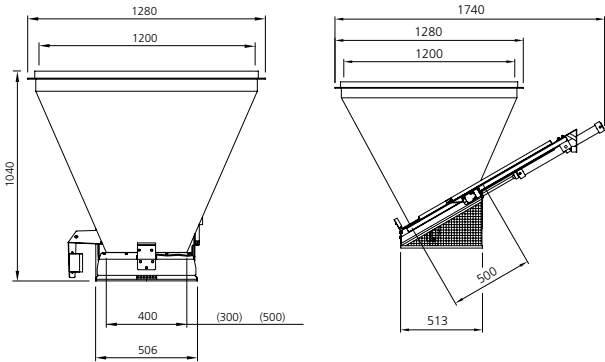

Better baking business.

A Member of the Sveba-Dahlen Group AB